

GRID ROW +47'-0"

30 FULL STAGE BLACK
29 CYC
28

27 IS ELECTRIC
26 BLACK SCRIM
25 WORKS
24 BORDER

23 14 ELECTRIC
22 STRING CURTAIN
13 ACOUST

21 TUBES 4
20

19 13 ELECTRIC
18 LEGS
17 BORDER

16 WORKS
15 TUBES 3
14 STRING CURTAIN
13

12 ACOUST

12 12 ELECTRIC
11 LEGS
10 BORDER

9 WORKLIGHTS (GRIDDED)
8 TUBES 2
7 STRING CURTAIN
6 BORDER

(ACOUSTIC SHELLS)
5 TUBES & LEGS

4 11 ELECTRIC
3 STRING CURTAIN
2 BORDER
1

CYC
= 5 ELECTRIC
BLACK SCRIM
BORDER TRIM 21'-0"
= 4 ELECTRIC

= 5 ELECTRIC
LEGS
BORDER TRIM 20'-6"

= 2 ELECTRIC
LEGS
BORDER TRIM 21'-0"

TUBES
BORDER

= 1 ELECTRIC
LEGS
BORDER TRIM 23'-0"

REMOVE BOTH TECH ROOMS IN THE
HOUSE WITH STRING CURTAINS.
CREATE ABOOTH TO EFFECT AS
MUCH AS POSSIBLE TO BE
MOUNTED ON THE WALLS OF THE
CONTROL ROOM.
KEEP THE UPPER TECH BOX
AVAILABLE FOR LIGHTING.

CONTROL ROOM

CONTROL ROOM

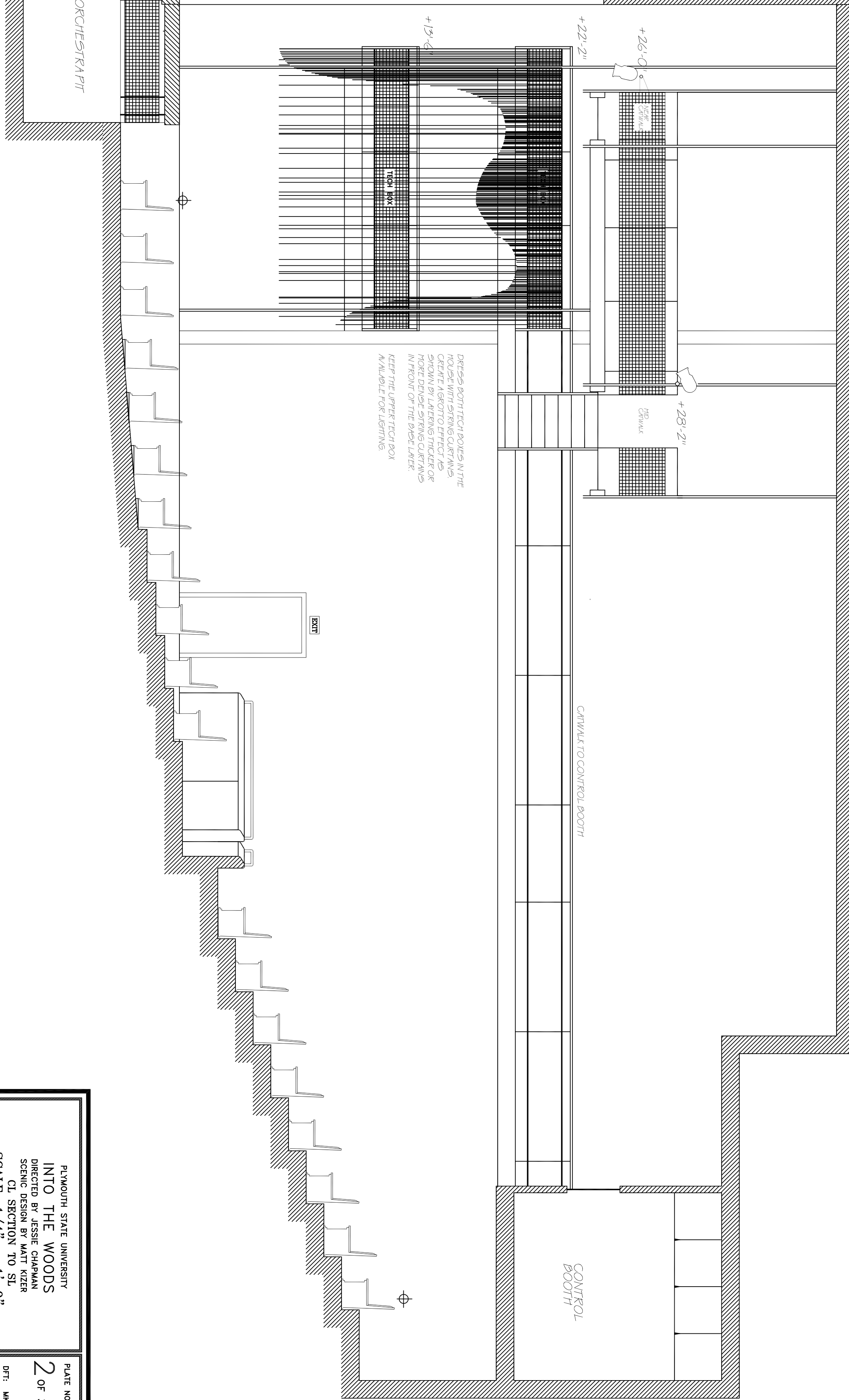

PLATE NO.
2 OF 3
PJM, JK
P43822

Plymouth State University
INTO THE WOODS
DIRECTED BY JESSIE CHAPMAN
SCENIC DESIGN BY WALT KIZER
CL. SECTION TO SL.
SCALE: 1/4" = 1'-0"